



Hunters Retreat

Marton | Cheshire



Hunters Retreat

Cassia Green, Marton
Cheshire, CW7 2PZ

A well-positioned, 3-bed purpose-built log cabin with equestrian facilities and 4.28 acres.

- Private 3-bedroom property with spacious living accommodation
- Modern and stylish kitchen with integrated appliances and AGA
- Living room with wood-burner and double doors onto patio and garden
- 3 bedrooms, one with shower en-suite.
- Family bathroom
- Patio and mature gardens
- Timber range building with 6 stables
- Additional storage buildings
- 4.28 acres
- EPC rating C



Approximate distance in miles:
Whitegate 0.5m | Northwich 4.5m | Tarporley
7m Chester 17m | Manchester 30m | Liverpool
39m

Situation

Hunters Retreat is set in a rural, yet accessible location, just outside the village of Whitegate. The property is a short distance from the A556, offering an easy commute to Chester and Manchester.



The property was constructed to a high standard in 2013, having received planning permission to build and erect a holiday lodge. The property is restricted to holiday use only and can not be used as permanent residential occupation.

Hunters Retreat is located between Foxwist Green and Marton, near Whitegate and within a short distance of Winsford and Northwich. Both towns offer a wide range of facilities and amenities. The popular villages of Tarporley and Knutsford are nearby and offer retail shops, restaurants and schools.

There are excellent schools in the area at primary and secondary level, including first rate private education at the nearby Kings and Queens schools in Chester. Northwich is also home to three highly rated comprehensive schools and The Grange School is well renowned.

There are numerous sports facilities in the area including: football, tennis, bowling, cricket and running clubs at Winsford and Northwich. There are golf courses at nearby Vale Royal Abbey and Sandiway Golf Course as well as the renowned Delamere Golf Club.

Notwithstanding the various facilities and amenities mentioned above, by far the most appealing is great horse-riding from the doorstep, with the Whitegate Way nearby offering six miles of bridleway and spectacular views across the Cheshire countryside. Delamere Forest is nearby and there are several local high class equestrian facilities at Kelsall Hill Equestrian Centre and Southview Equestrian Centre.





Description

Hunters Retreat has a private drive off Cassia Green with timber electric gates. The drive leads up to the side of the property where there is ample parking. The timber lodge offers excellent family accommodation, large garden and surrounding land with beautiful countryside views.

The property is entered from the rear door and into the kitchen. This element of the property was extended in 2017 and finished to a very high standard. The modern and contemporary kitchen has a range of ground and wall mounted units, which provide plenty of storage space and integrated appliances. There is a modern two oven gas AGA with adjacent module which has two electric ovens and gas hobs above.

Adjacent is the living room with feature fireplace housing a wood-burner and double doors leading onto the rear patio and garden. Through the living room is the main hallway with access to the front door and porchway. Off the hallways are the bedrooms, three in total, one of which has a shower en-suite. There is a further family shower room.



Externally

The property has a large garden mainly laid to lawn with mature trees and shrubs to its perimeter. There are two patio areas to the front and rear of the property and a summer house in the corner of the garden.

There is a range of timber stables with 6 boxes in total. This building sits on a concrete pad with water and power connected. There is a further timber range for secure tack and feed room and plenty of storage space. Adjacent to the stables is a handy turnout area.



The 4.28 acres is all down to grass and divided into 4 paddocks, all of which are divided by electric fencing with post and rail to parts.

Directions

From Chester proceed east on the A51 towards Tarvin. At the Tarvin roundabout, take the first exit on the A54. After approximately 1 mile you will enter a dual carriageway. Upon exiting the dual carriageway, keep right on the A556. Continue along this road and through the traffic light crossroads. At the next traffic lights, turn right onto Dalesford Road. Continue for approximately 2 miles and turn right onto Cassia Lane. At the junction turn right onto Cassia Green and the property is located on the right.

Services

Mains electricity, water, gas central heating and hot water
Mains drainage
EPC rating C

Viewing

Strictly by prior appointment with the agents Jackson
Property 01743 709249.

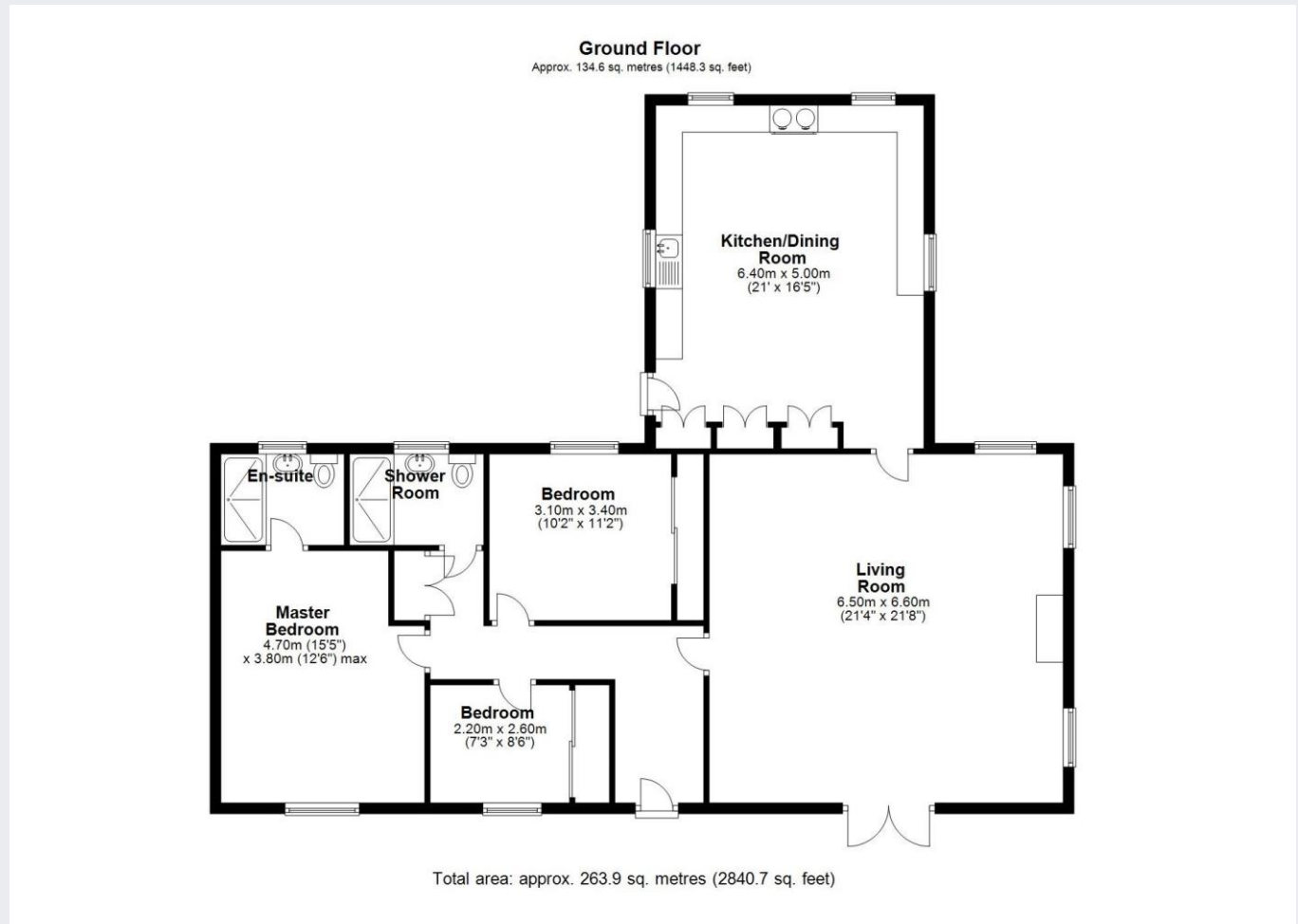

Shropshire (Head Office)
Address: Franks Barn, Preston on Severn, Uffington, Shrewsbury, SY4 4TB
Contact Number: 01743 709249

Website: jackson-property.co.uk
Email: info@jackson-property.co.uk

JACKSON PROPERTY LTD for themselves and the vendors of the property, whose agents they are, give notice that these particulars, although believed to be correct, do not constitute any part of an offer of contract, that all statements contained in these particulars as to this property are made without responsibility and are not to be relied upon as statements or representations of fact and that they do not make or give any representation or warranty whatsoever in relation to this property. An intending purchaser must satisfy himself by inspection or otherwise as to the correctness of each of the statements contained in these particulars. The agent has not tested any apparatus, equipment, fixture, fittings or services and so cannot verify that they are in working order, or fit for their purpose, neither has the agent checked legal documents to verify the freehold/leasehold status of the property. The buyer is advised to obtain verification from their solicitor or surveyor.